

SALISBURY GROUP OF ARTISTS NEWSLETTER

August 2023

Issue 70



INSIDE

Our cover artist Colin Knapman tells us his story

Martin Webster SGA Chairman looks back on our Summer Exhibition.

And lots more

Contents

Notes from the Editor	2
Our Chairman Martin Webster looks back at our successful Summer Exhibition	3
Featured Artist of the Month – Colin Knapman	4
Workshops New for Autumn	7
Visit to the Rifles Museum Garden on Sunday, August 20th.	8
WILTON Freehand Art Group	9
.....	

Notes from the Editor

It is almost the end of August and here I am again rushing to write this piece. Will I finish in time to legitimately say it is an August newsletter that I am publishing? Have you noticed that life rushes by quickly and a bit like your paint drying too quick on your canvas it is difficult to manage.

The Summer Exhibition was a great success and Martin writes within this Newsletter to acknowledge and celebrate this. Additionally, the words from Annie that I capture below again show the fantastic team effort it was!

‘Thank you to everyone who participated in our Summer Exhibition, to every exhibitor, to every Steward and to our great exhibition and hanging team. You have all made our SGA Summer Exhibition a great success.’

Congratulations to our winners of the People’s Choice Vote, who are as follows;

- 1st. Angela Cox ‘A Hand for Survival’ (£100 prize)
- 2nd. Sandra Hammer ‘Winter in the Dales’ (£50 prize)
- 3rd. Jane Walker “Fowler Rd.” (£25 prize)

I love the opportunity of finding time (usually bedtime) to read whether fiction or factual stories. I have just finished a book that is perhaps a mixture of both that I would recommend. The concept is novel but for me really worked. The title is ‘I, Mona Lisa’ and it is written by Natasha Solomons . it is the story of that fantastic picture by Leonardo da Vinci and it takes you through her story with her voice. The voice is the clever bit. As the promotion on the book cover says . ‘You’ve seen her smile now hear her voice.’

Some years ago I crowded in front of her in Paris with others to see that smile and now hearing the voice from within this book it is a delight. It is really recommended.

Some words written by da Vinci himself and quoted in the book is worth noting now .

‘The painter makes his work permanent for very many years, and of such excellence that it keeps it alive.....’

Best wishes,
Terry

Our Chairman Martin Webster looks back at our successful Summer Exhibition

'The 2023 annual exhibition of the Salisbury Group of Artists has been a great success, in all sorts of ways. A record number of entries plus a gorgeous small pictures section has really made an artistic statement to Salisbury and wider. I have heard many complimentary comments about the exhibition, about its range and diversity, and above all the general level of talent and imagination.

To my eye its been good to see so many of our new members bringing fresh eyes and approach to painting, photos, sculptures and ceramics.

To date we have sold more works than I was expecting (maybe Im too pessimistic about things...) and certainly way better than our exhibition in the spring.

Annie George as our lead on exhibitions and all things hanging (!) has excelled herself and coped with multiple tasks and demands upon

her in an exemplary fashion, but also wonderfully supported by a large and enthusiastic group of volunteers, to organise, print, hang, steward and do all the backroom stuff to make this so successful. My I say well done to you and well done SGA!

The next exhibition will be at the hospital starting around mid November. We then look forward to the next exhibition at the library in the spring - so there is lots to get painting for over the Autumn and Winter, as well as the workshops, sketching opportunities, and social painting on our Friday afternoon to look forward too!

Thank you

Martin , Chair of SGA"



Featured Artist of the Month – Colin Knapman

Terry talks to member artist and garden designer Colin Knapman to discover how he mixes green fingers and paint stained fingers!



Terry - You are by profession a Garden Designer which no doubt involves your artistic skills as much as your gardening knowledge. Where did it all start, with your artistic skills or your green fingers ?

Colin - After a busy working lifetime in the exhibition industry, designing and building exhibition stands for individual clients, involving plenty of travelling and working many unsociable hours I was fortunate enough to sell my business in order to take on new challenges. Like the Roman generals of old and the Whigs and Tories of the 18th C I retired to my country 'estate' in the New Forest and took up horticulture. In order to do this properly I enrolled on a Garden Design course at Sparsholt College for four years and obtained a 1st class degree in Garden Design.

It was important that we could not only design our gardens on a computer with CAD systems but also to have the ability to do quick sketches directly with clients, which they naturally

preferred and were much easier to understand than the architectural plans spewed out by computers.

I naively compare my sketches with that of Joseph Paxton and his initial sketches of The Crystal Palace at the Great Exhibition of 1851 in Hyde Park which were done on table napkins, but maybe that is a too big leap of anyone's imagination!

My tutor at Sparsholt was a great enthusiast of garden history and the historic country houses of that period which rekindled my interest in architecture and the English Garden Landscape movement. This popularised people like William Kent, Lancelot 'Capability' Brown and Humphrey Repton many of which were also accomplished artists and were heavily influenced by the Grand Tours of Italy and the great landscape artists Nicolas Poussin and Claude Lorrain

Having completed the course I set about running my design consultancy business for the next 15 years, but now on a reduced scale and slowly heading towards retirement. Since Covid, and that break from work, I became more interested in sketching with pen and watercolours whilst preferring outdoor sketching whenever possible. I belong to the Urban Sketchers group in Bournemouth and Southampton and now the SGA with Loraine Sherlock's very enjoyable Sunday sketching in and around Salisbury.



Now as I am answering your questions it occurs to me that I am unconsciously developing 3 different styles, Firstly, the garden design sketches for clients to see what their gardens could look like which includes my plein air painting groups. Secondly, the finished and framed architectural watercolours of local landmarks as I had on display at the Antelope Café and more recently, as mentioned, my first foray into Pop Art with my 'Tea Bags' and 'Shoes'

Terry - If you were to win the Lottery or indeed decide to retire where would your artist bent take you. Would you change your media, would you experiment with other styles.

Colin - I fear that if I won the Lottery I would become lazy but when I do eventually fully retire I would like to visit more art exhibitions and venues, and we are blessed with so many locally such as Hauser & Wirth in Bruton, Messums in Tisbury and Roche Court near Salisbury, along with the many venues in London. The Angel of the North is on my Bucket list as is Frank Lloyd Wright's Guggenheim Museum in New York and Frank Gehry's Guggenheim Museum in Bilbao, both combining art and architecture.

As my early adult life was in the swinging 60's I love the art and music (but not the architecture!) of that period. So, I could easily delve back into Pop Art and experiment with acrylics, marker pens along with various mixed media and collage work. I have already dabbled with this style with my recent attempt currently at Gallery 4 Summer Exhibition at the Salisbury Library with my 2 works 'Tea Bags' and 'Black Shoe', which were strongly influenced by Andy Warhol and his Campbell's Soup Cans.



Terry - Who is your hero or heroes within the artistic world. Perhaps we should add a rule that it cannot be another gardening designer artist.

Colin - My artistic heroes tend to be those who make the most of the materials and technology around them. In particular my top most influential works and artists would be Marcel Duchamp and his Readymade art the 'gent's urinal', Andy Warhol and his bold, repetitive screen prints, David Hockney and his incredible photographic collages, and finally, it's a toss up between Damien Hirst and Tracey Emin I don't say I like all their works but they are of their time and get you thinking.

Terry - Is there three key pieces of good advice you could give to aspiring artists – of all ages – what would they be?

Colin - My advice to any budding artist is that it is never too late to start and to just enjoy experimenting

Do what you like !– it's your imagination, unleash it to the world, surprise and give pleasure to others. I try to sketch a bit everyday, not finished works of art, just quick doodles or sketches of anything around. It helps to make you more observant and understand perspective, composition, shadows etc.

Watch as many Youtube and Facebook videos as you can, there's tons of free tips and advice out there make the most of them and develop a style the suits you and your ability best.

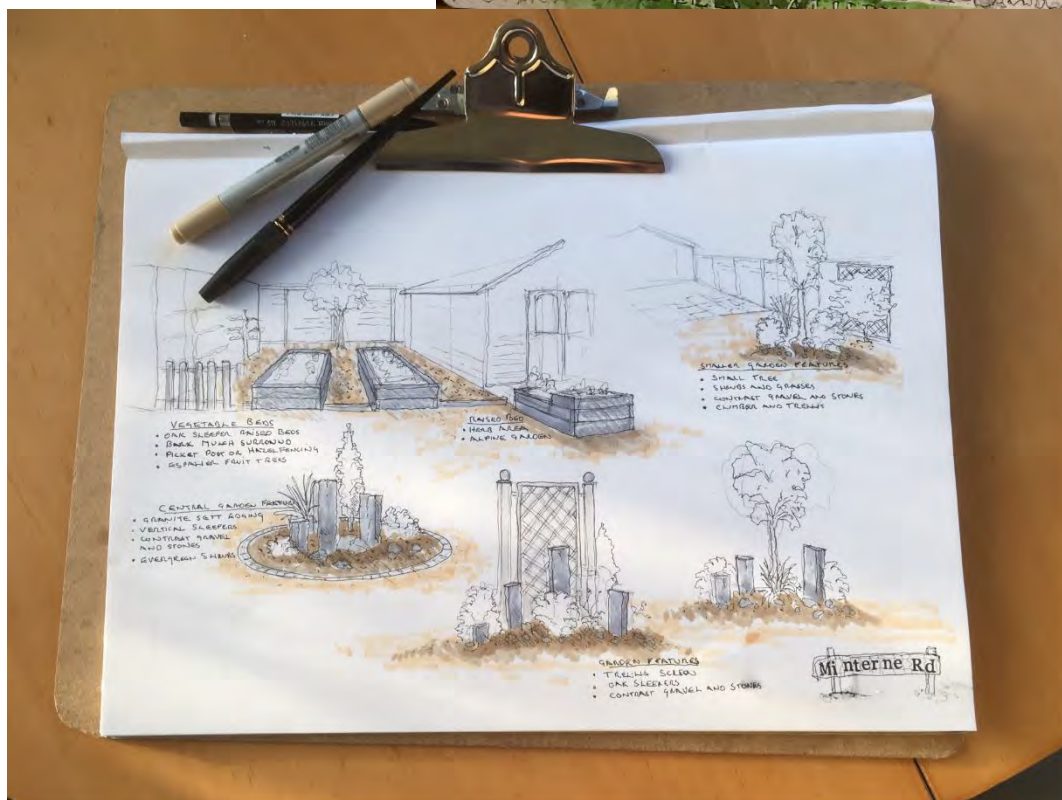

Workshops New for Autumn

By Annie George

September 23rd; Clare Goodman, Winchester Artist, brings you '**Tips and techniques in Watercolour**', which is Clare's most loved medium, to further develop your watercolour painting. Clare describes herself as 'no longer a traditional watercolourist, but offering a fun and explorative approach, combining watercolour with pastel, inks and collage!'



Saturday October 14th (extra date) Karen Welsh, 'Abstraction**'.** This is Karen's second session this year, sharing further her journey into Abstraction. It is not essential to have attended in January as Karen is very experienced at differentiating and developing each individual's potential.

Saturday October 28th Karen Coulson 'Getting the best out of Coloured pencil art**'.** Karen is an highly recommended and award

winning artist in this medium. Prepare to be inspired! More info. next month.

Saturday November 11th (extra date) Helen Southwell's Fused Glass workshop 'Christmas Trees and hanging Christmas decorations**'.** Helen returns by the popular demand of her May groups! Morning and afternoon sessions of 8 participants each @ £20 each. Book early to avoid disappointment!

Saturday November 25th Martin Webster 'Painting Snow**'.**

Martin, our Chairman leads a workshop on painting snow. Many of you will know how popular Martin's work is, and how well it sells! He will share his secrets of successfully painting snow!

Christmas Social; date for your diary; Saturday 9th December. Details later!!

Workshop fees; Members £30 per day, guests £40

To pay by Bacs;

Salisbury Group of Artists

30 97 41

acc. 03627988 ref; workshops

(alternative payment methods available).

To book any of the above workshops please contact; Rose@duly.org.uk. All workshops are on Saturdays, 10am-4pm, at Bemerton Methodist Hall, Roman Road, Salisbury, SP2 9BH.

Please feel free to contact me if you have any questions about a particular workshop ; annie.george2308@gmail.com

SALISBURY SKETCHERS

Visit to the Rifles Museum Garden on Sunday, August 20th.

From Loraine Sherlock

It was a perfect sunny afternoon for our sketching event in the attractive garden of the Rifles Museum. There were plenty of spots to choose from in sun or shade, and several benches scattered around that were probably more comfortable to work from than our stools or folding chairs. When we first arrived an Historical Enactment Group dressed in military uniform had tents pitched in front of the house, and although interesting to see their equipment and uniforms, luckily they were in the process of packing up leaving us with a clear view of the building and the opportunity to depict it.

It is fascinating to discover these gardens hidden behind some of the Close houses. There is a very ancient copper beech tree in the centre of the lawn of the Rifles garden that has lost some of its enormous branches over the last couple of years, but it is still magnificent and I wondered what events it

had witnessed during its dominant reign over all the other trees and plants.

Our next sketching location is at the Breamore Estate on Sunday,

September 17th, from 2.00 pm onwards.

Breamore House is on the A338 Salisbury to Ringwood Road, and if coming from Salisbury is the next village after Downton. It is clearly signposted just before, and also in the village. Follow the signs to the free car park, and I will be in the courtyard area between 2.00 pm - 2.15 pm.

If you would like further information, please contact me on 07496894568 or

Email paperstitch@icloud.com. I have a couple of places left in my car for anybody who does not own a car.



WILTON Freehand Art Group



We are a group of mixed ability artists who meet on a Thursday afternoon between 2pm and 4pm in Room 3 at Wilton Community Centre , opposite the Italianate Church

We use different mediums, watercolour, acrylic, pastels, drawing and mixed media (oils not permitted).

We are a very sociable bunch and enjoy our art afternoons with tea, coffee, biscuits and a bit of art thrown in.

Our new term starts on Thursday, 14th September and we usually have a 12 week term.

We would love to welcome a few new members to join us. If you are interested please call me on

01980 622775 or 07852509630

Kathy Gevaux



BREAMORE HOUSE

Breamore Countryside Community Hub

Breamore countryside museum was started 50 years ago to celebrate the self-reliance of a pre 1950s British village. At the time, a village would host an array of different skill sets, each vital to the functioning of the village.



Alongside the Countryside Museum, is a modern day version of a working village. Our community hub supports a host of different independent business all operating at the same location.

The site itself, lies within a beautiful walled garden, between the New Forest and Cranbourne Chase national parks. It's a popular walking destination, with a café, farm shop, stately home and countryside museum all operating within the same site.





BREAMORE HOUSE

We're looking for artisan crafts professionals to take up residence within our Apple Rooms to use as their studio and or workshop. The space should also be used to market and sell your work to visitors.

To apply, we will need to see a copy of your portfolio by the 30th Sep 2023. The

units rent will be £400 pcm, bills included.

As well as being able to demonstrate a high standard of work within your craft, applicants should be able to commit to the following points:

- Being open a minimum of 4 days a week
- Keep the space tidy and presentable to visitors
- Have a friendly demeanor to visitors
- Provide any branding to hang on their unit

For all those interested, we would love to hear from you via email. Please reach out to Westrow@breamoreestate.com

If you'd like to find out more about us, please take a look at our [Instagram](#) or [website](#).

SALISBURY ARTS SCENE



OUTDOOR
ARTS EVENTS
SUNDAY 6th SEPTEMBER
10-4

SALISBURY MARKET
PLACE - SGA WILL BE
THERE!!

Ian Southwell is now making a range of floating frames, ideal for canvas prints.

Frames are made to order, can be any size and painted white as standard (or primed ready for you to paint).

Sample costs are:

60 x 30 cm for £19

60 x 60 cm for £25

90cm x 90cm for £38

Every frame is made to order so please get in touch with Ian to discuss your requirements on 07847 409062 or email ian@iansouthwell.co.uk

SGA at The Antelope Café

Aug
1st
Sept
30th

**ANIMALS
A-GO-GO**

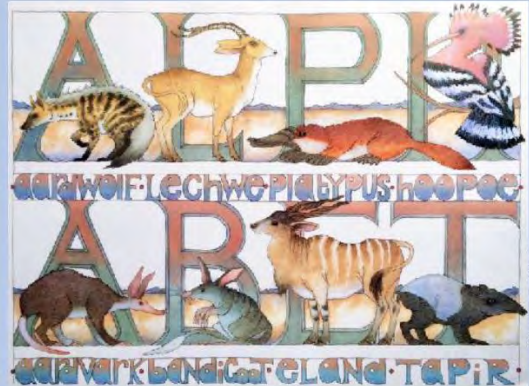

THE ANTELOPE CAFÉ
SALISBURY ANTIQUES MARKET,
37 CATHERINE STREET,
SP1 2DH
OPEN MON - SAT(except Wed) 10 - 5



Karen Welsh
ACRYLIC PAINTING WORKSHOPS

Share my passion for painting

Join me in a 1-2-1 or group acrylic painting workshop.

Ideal if you want to learn to paint with acrylics or want to improve your skills.

Thursdays 9.30 - 12.30 (bi-weekly)
Methodist Church Hall, Bemerton,
Roman Road, Salisbury SP2 9BH

For dates, booking and more information
www.karenwelshworkshops.co.uk
07515 482406

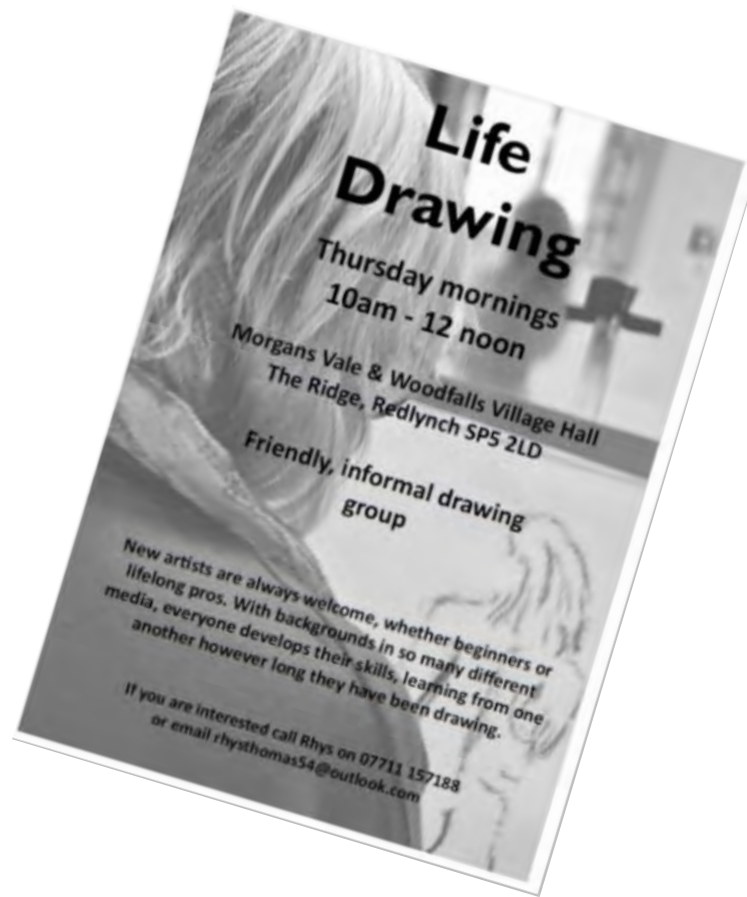

Belmont Fine Arts - established 2007 offering giclee and digital prints from business cards and greetings cards to 60inch wide canvas, A2 flatbed scanning and bespoke picture framing we are sure we will be able to help. We work with individual artists and photographers as well as commercial clients nationwide producing an excellent finish to showcase your work at its best. Visit us in our studio and barn just outside Salisbury to discuss your needs, choose mounts, mouldings and papers or just have a chat about how we can work with you. We are a friendly family run business with a growing customer base so drop us an email or give us a call and we look forward to hearing from you and working together soon. (We want to be able to give you our full attention so by appointment only please)

2 Belmont Cottages,
Southampton Road
Clarendon
Salisbury
SP5 3DE
(Opposite Kennel Farm)
07891 480240

FEES

ANNUAL MEMBERSHIP FEE £20 individual; £30 Family

WORKSHOPS £30 members (booking essential)

UNTUTORED LIFE CLASS £12 per session.

TALKS / SALISBURY SKETCHERS free.

FRIDAY ART £2 per session.

VISITS fees vary. See website/ newsletters

FRIDAY ART MEETINGS ARE HELD THROUGHOUT THE YEAR, EXCEPT AUGUST, AT METHODIST CHURCH HALL, ROMAN RD., BEMERTON, SALISBURY. SP2 9BH

FURTHER DETAILS OF ALL THESE EVENTS CAN BE FOUND ON OUR WEBSITE.

www.salisburygroupofartists.co.uk

CONTACTS

MINUTES SECRETARY JANE HANBIDGE

jane.hanbidge@icloud.com

FRIDAY ART Phone Josie and Ken Smith 01980 846508)

MEMBERSHIP PAUL RYDER 07818 423188 paulryder164@gmail.com

NEWSLETTER TERRY KEMP 01980 620256 newsletter@salisburygroupofartists.com

TREASURER ROSE DULY 01722 321544 roseduly@outlook.com

WEBSITE TERRY KEMP 01980 620256 newsletter@salisburygroupofartistst.com

WORKSHOPS ANNIE GEORGE 01722 326596 artworkshops@salisburygroupofartists.com

